



*This plan may show options available and may not reflect the actual home detailed.

FEATURING
"Boucher"



See your ENVISION Home at Last builder for details.



Remember when the

Raised Ranch was the house to build? There was a reason for that, it was not only an economical use of space, but sported an attractive façade that fit right into the neighborhood. We've revived that look in our Boucher plan, but updated it with an open kitchen/dining/great room concept.

You will still get all of that fantastic lower level space to finish as you will. We've shown you an option for a family room, two additional bedrooms, a laundry and full bath. You can decide how much or how little you need right now and take it from there.

So if you are trying to get a big bang for your buck, look no further, it's all right here. We knew this timeless traditional plan would be just the one to make you feel that you were...*Home at Last.*



A BLENKER BUILDING SYSTEMS COMPANY
ENVISION
Home at Last

www.envisionhomeatlast.com

"Boucher"

1st Floor



Plan Info

Total Square Feet = 939
 58' x 30' (Max Width/Depth)
 (2) Bedrooms
 (1) Bathrooms

*Optional Lower Level = 884 Square Feet

Lower Level (optional)

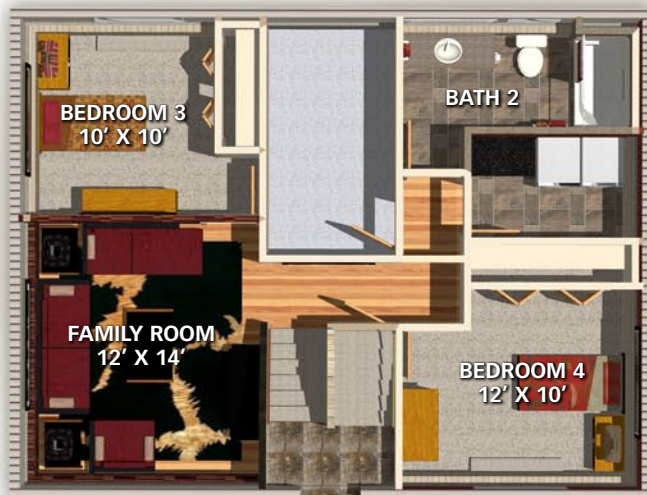

3D

See your ENVISION.Home at Last builder to view a 3D walk-through of this model.

Nostalgia
 custom home collection



Marcel Boucher

Marcel Boucher immigrated to America to work for Cartier in New York in the 1920's. Fortunately for collectors, the Great Depression forced him to transfer his considerable talents to the costume jewelry industry. Often innovative, his work is characterized by exquisite metal work and fabulous rhinestones that bear a remarkable resemblance to real gemstones.



A BLENKER BUILDING SYSTEMS COMPANY
ENVISION
 Home at Last

www.envisionhomeatlast.com